

# Rebar Rockbolts (Forged Head & Threaded)

## #6 (20M), #7 (22M) and #8 (25M)

### FORGED HEAD REBAR

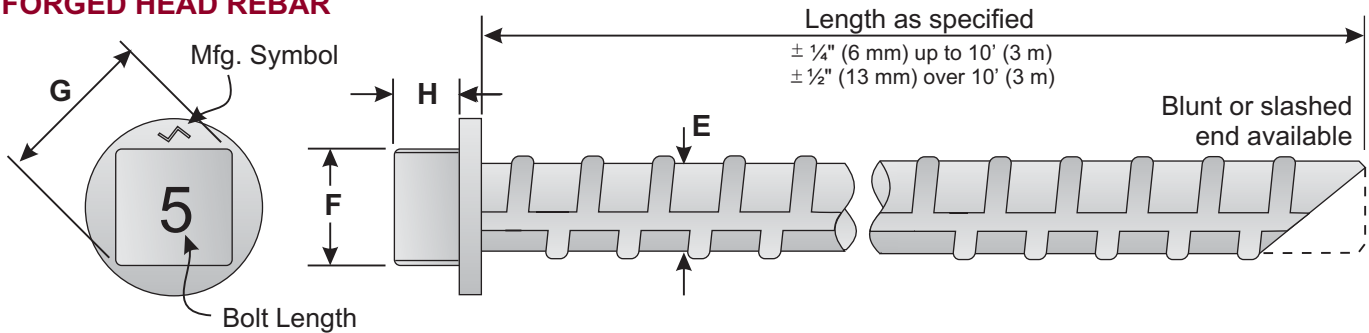

### THREADED REBAR

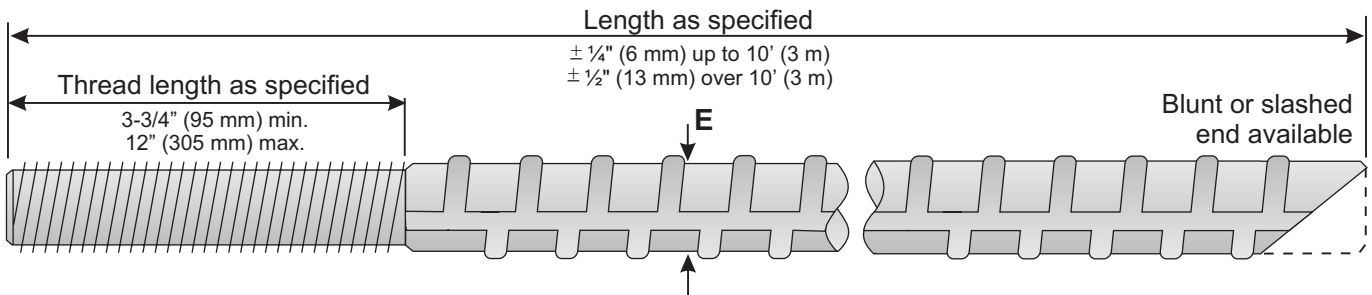

### DIMENSIONS:

	#6 (20M)	#7 (22M)	#8 (25M)
<b>E</b> Nominal Bar Size	0.768" (19.5 mm)	0.874" (22.2 mm)	0.992" (25.2 mm)
<b>F</b> Head Across Flats	1.088" to 1.125" (27.64 mm to 28.58 mm)		n/a
<b>G</b> Head Across Corners	1.425" to 1.591" (36.19 mm to 40.41 mm)		n/a
<b>H</b> Head Height, min.	0.40" (10.2 mm)		n/a
<b>I</b> Threaded Size, (left and right)	3/4"- 10 UNC	7/8"- 9 UNC	1"- 8 UNC

All dimensions & tolerances in accordance with ASTM F432 & CSA M430 specifications

### TECHNICAL DATA - FORGED HEAD

	#6 (20M) Rebar	#7 (22M) Rebar
Yield Strength, min.	27,000 lbs (120 kN)	34,850 lbs (155 kN)
Tensile Strength, min.	40,500 lbs (180 kN)	52,250 lbs (232 kN)
Ultimate Axial Strain	10% minimum	

All mechanical and physical properties in accordance with ASTM A615, CSA G30.18M & CSA G30.12M specifications

### TECHNICAL DATA - THREADED

	3/4" UNC Thread	7/8" UNC Thread	1" UNC Thread
Yield Strength, min.	20,800 lbs (93 kN)	26,900 lbs (120 kN)	34,600 lbs (154 kN)
Tensile Strength, min.	30,600 lbs (136 kN)	40,350 lbs (180 kN)	51,900 lbs (231 kN)
Ultimate Axial Strain	10% minimum		

All mechanical and physical properties in accordance with ASTM A615, CSA G30.18M & CSA G30.12M specifications

# Installation Accessories

## Rebar Rock Bolts

### NUTS

#### DOMENUTS

- for 3/4" thread A.F. = 1-1/8" square
- for 7/8" thread A.F. = 1-1/8" square
- for 1" thread A.F. = 1-5/8" hex

#### PLAIN NUTS - used with pinched thread

- for 3/4" thread A.F. = 1-1/8" square
- for 7/8" thread A.F. = 1-1/8" square with flange
- for 1" thread A.F. = 1-5/8" hex

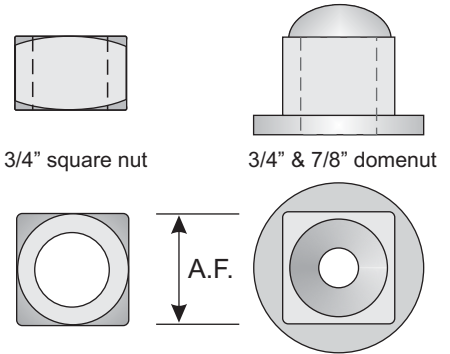

### HARDENED ROUND WASHERS

- to ASTM F436 specifications
- for 3/4" thread:
  - I.D. = 13/16", O.D. = 1-15/32", T = 0.122" to 0.177"
- for 7/8" thread:
  - I.D. = 15/16", O.D. = 1-3/4", T = 0.136" to 0.177"
- for 1" thread:
  - I.D. = 1-1/8", O.D. = 2", T = 0.136" to 0.177"

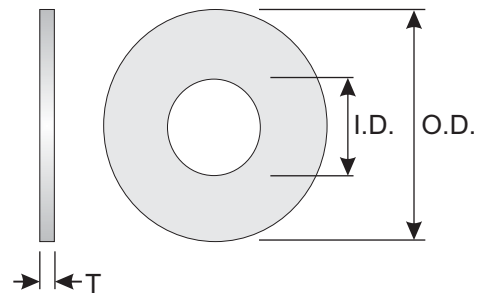

### SPHERICAL SEAT (COMPENSATION) WASHERS

- ductile iron ASTM A536 Gr. 65-45-12
- for 3/4" thread:
  - I.D. = 13/16", O.D. = 2", H = 13/16" (model TSW)
  - I.D. = 15/16", O.D. = 2", H = 1/2" (model TSW-4)
- for 7/8" & 1" thread:
  - I.D. = 1-1/16", O.D. = 2", H = 1/2" (model TSW-1)

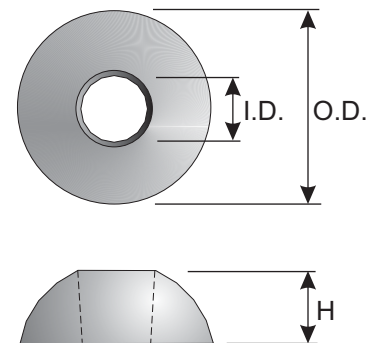

### INSTALLATION TOOLS - for stopers/jacklegs

#### FORGED HEAD REBAR DRIVER (DOLLIE)

- 1-1/8" square driver
- available with 7/8" hex socket or 3-1/4" long hex shank

#### THREADED REBAR NUTRUNNERS

- 1-1/8" square nutrunner (for 3/4" & 7/8" bolts)
- 1-5/8" hex nutrunner (for 1" bolts)
- available with 7/8" hex socket or 3-1/4" long hex shank

1-5/8" hex nutrunner  
with 7/8" hex shank

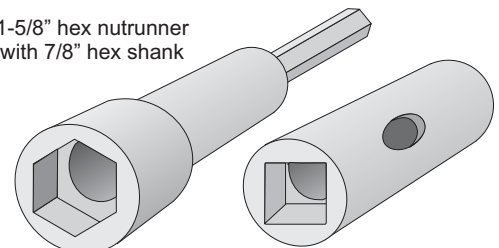

1-1/8" square nutrunner  
with 7/8" hex socket  
and optional ejector hole  
for domenuit "caps"